

HOSE REELS: 504 SERIES

50' Maximum hose capacity



Hose Reels



Roller arm in tank/wall mount position



Roller arm in ceiling mount position

504 Series HD Double Pedestal Arm Hose Reel

Full metal, heavy-duty, double pedestal arm hose reels, with hose capacity up to 50' x 1/2" hose

Very tough construction

Able to withstand constant use and abuse in intensive duty applications

Fatigue resistant steel spring

For years of durable performance and even load when pulling and recoiling the hose

Fully ported shaft and swivel

For better flow

Spool mounted on two permanently lubricated and sealed ball bearings

To reduce torque load on spring for smooth retraction and longer life

Large latching area for easier operation

Reducing Adaptor

Low pressure reels with 3/8" hose come with a 3/8" x 1/4" reducing adaptor for use with hose accessories

Hose guide arm

Can be placed in different positions to accommodate any method of mounting

Narrow footprint

Allows mounting more reels in the same surface area

Hose reels with hose include 30" inlet hose and ball stop

Hose reels offer four mounting positions

May be mounted in floor, wall, ceiling and tank positions

Hose reels are delivered in the ceiling mount position

For reels delivered with arm in side mount position, add the suffix SM to the hose reel part number. i.e. 504 101SM

MARKETS SERVED

- Car and truck dealers
- Service shops
- Fleets
- General manufacturing
- Service stations
- Lube trucks
- Mining and construction
- Railroad and mass transit

FLUIDS HANDLED

- Air
- Water
- Antifreeze & windshield wash solutions
- High pressure hot water
- Synthetic and mineral oils
- Grease

IN(MM)

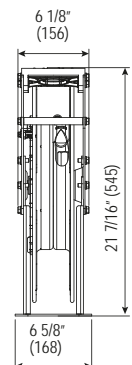
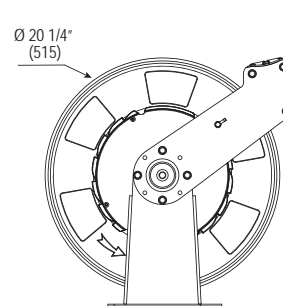
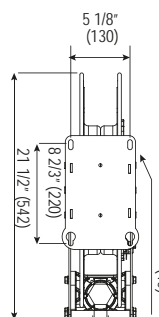

TECHNICAL SPECIFICATIONS

Operating Temperature Range

Air / Water / Antifreeze	-20°F to 140° F (-20°C to 60°C)
Oil	-22°F to 194°F (-30 °C to 90°C)
Grease	-22°F to 194°F (-30 °C to 90°C)

Wetted Parts

Air / Water / Antifreeze	Brass, acetal, Nitrile rubber
Oil	Steel, electro-less nickel plated steel, Nitrile rubber
Grease	Steel, electro-less nickel plated steel, Nitrile rubber, PTFE

Weight *without hose*

49 lb (19 Kg)

Manual

850 838

CUSTOM COLORS

Verify lead times for customer colors

Reel Part No. + letter	Reel color	Color
standard color	Reel color, white	RAL 9016
504 xxxK	Reel color, black	RAL 9005
504 xxxL	Reel color, blue	RAL 5005
504 xxxR	Reel color, red	RAL 3011



Hose Reels

ORDER INFORMATION

Part No.	Hose Length	Hose I.D.	Outlet thread	Max. Working Pressure	Net weight	Reel only with swivel Part No.
LOW PRESSURE AIR/WATER antifreeze and windshield wash solutions - brass shaft and acetal swivel - inlet 1/2" NPT(F)						
504 151	50'	3/8"	3/8" NPT(M)	300 psi	49.5 lb	504 159
504 150	50'	1/2"	1/2" NPT(M)	300 psi	52.8 lb	504 159
MEDIUM PRESSURE OILS steel shaft and swivel - inlet 1/2" NPT(F)						
504 250	50'	1/2"	1/2" NPT(M)	2,000 psi	57.3 lb	504 259
HIGH PRESSURE GREASE steel shaft and swivel - inlet 3/8" NPT(F)						
504 350	50'	1/4"	1/4" NPT(M)	5,000 psi	58.4 lb	504 359
504 351	50'	3/8"	1/4" NPT(M)	4,000 psi	60.6 lb	504 359

MOUNTING BRACKET for use with 504 series hose reels in a bank. Nuts, screws and washers included.

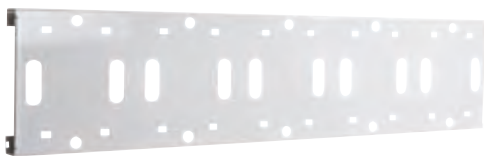

360 114	Holds up to two reels. Dimensions: 21 1/2" x 12"
360 115	Holds up to three reels. Dimensions: 32 1/2" x 12"
360 117	Holds up to five reels. Dimensions: 54 1/2" x 12"
1390	Channel mounting bracket. Channels may be mounted from I-beams with use of channel mounting brackets (up to 9" flange). Order two brackets for the two and three reel channel and three brackets for the five reel channel